

TruSlope's One-slope shower trays are made of dense Expanded Polystyrene also known as high density Styrofoam. TruSlope's One-slope shower trays are a viable alternative to the traditional sand mix shower mortar beds, especially when the low-profile and no-curb shower applications are desired.

OASI® One-Slope shower trays are specifically designed to be used in conjunction with OASI® TruLine linear drain, and the Trugard® Vapor-shield or Steam-shield waterproofing membrane system.

The popular trend of the One-slope shower trays has come about primarily due to today's Incredible craving for at-home commercial spa-like retreats. Linear drains give great flexibility in design as well as a luxurious elegance and a pampered atmosphere that meets the extreme need to escape for some "me time" to unwind from today's fast pace high demand world and to "recharge" to meet another stressful day. The "craze" of transforming traditional task oriented bathroom into an escape oasis, often include barrier-free shower entrances built-in seats, benches, and adequate inset niches.

Note: Small format tile such as mosaics and other small format tiles smaller than 4" x 4", require cement board or Hardboard to be installed on top all polystyrene trays, because a very strong or heavy concentrated pressure downward may allow the small tiles to press downward into the tray when installed directly onto the tray. Therefore, installation of tiles directly onto the TruSlope shower trays require floor tiles to be no smaller than 2" x 2" square for all **Standard TruSlope Center Drain trays**, and **Standard One-slope trays** & **Low-profile Curbless One-slope** trays require 4" x 4" square tiles or larger.

A major benefit of one-slope tray however, is that large format tiles can be used and are generally preferred over small format tile, because less grout maintenance is needed.

Note: For low-profiles trays over wood subfloor installations, adequate blocking support under the wood subfloor area shall be installed per code, also blocking around the drain trench cut out hole area shall always be installed with all trays.

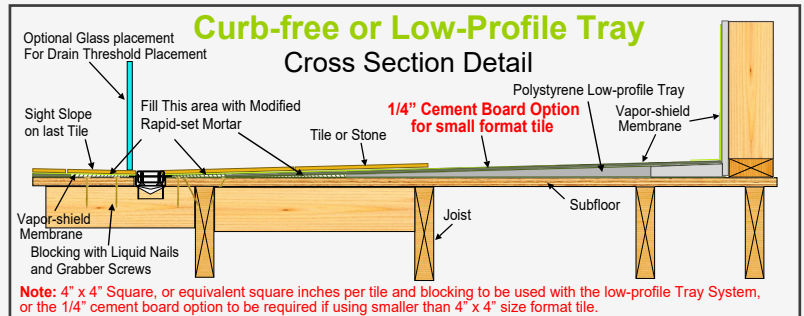

TruSlope LD49x41-L
49.5" x 41" **CURBLESS** Tray
Fit up to 48" Linear Drain

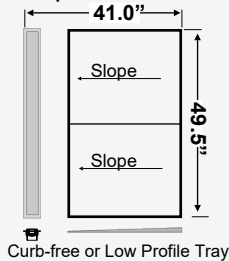

TruSlope LD49x78CP-L
49.5" x 78" **CURBLESS** Tray
Fit up to 48" Linear Drain

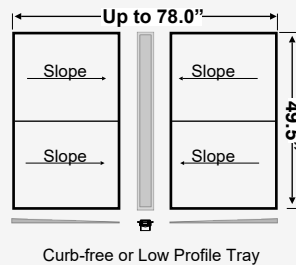

TruSlope LD49x60-SCP
STANDARD Tray Center Placement

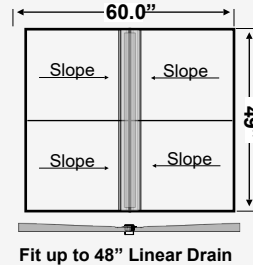

TruSlope LD74x41-L
74" x 41" **CURBLESS** Tray

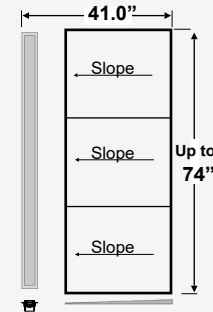

TruSlope LD74x78CP-L
74" x 78" **CURBLESS** Tray

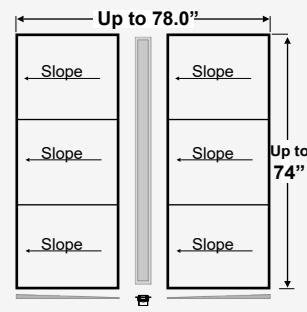

TruSlope LD74x60-SCP
STANDARD Tray Center Placement

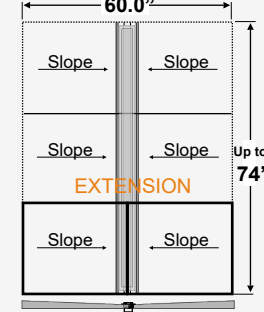

TruCurb Shower Curbs

Note: Curb required for STANDARD OneSlope Trays.

TruCurb 4x5x36,48,60, or 72"

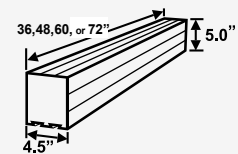

Low-profile Design
Customer Preferred

TruSlope LD49x60-S

49.5" x 60" **STANDARD** Linear Drain Tray
Fit up to 48" Linear Drain

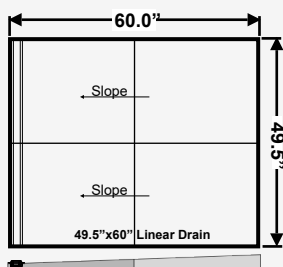

TruSlope LD74x60-S

74" x 60" **STANDARD** Linear Drain Tray
Fit up to 72" Linear Drain

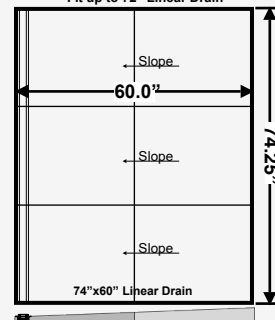

TruSlope LD50x60-L

49.5" x 60" **CURBLESS** Tray
Fit up to 48" Linear Drain

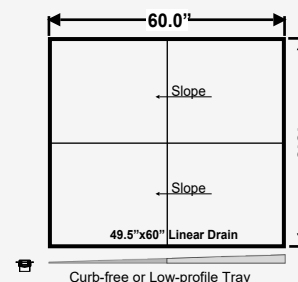

TruSlope LD75x60-L

74" x 60" **CURBLESS** Tray
Fit up to 72" Linear Drain

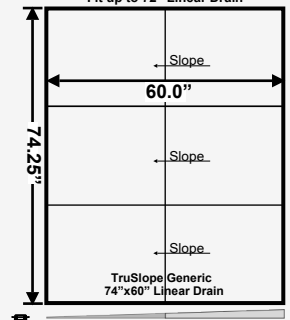

TruSlope... Make it Leak-proof, Easier & Faster

Why Curbless Trays?

- No Curb Needed
- Much Easier and Faster Install
- No Cutting of Floor Joists
- Tray Sits on existing Subfloor
- Wheel Chair Accessible
- Easy-entry for Elderly & Not So Old
- Large format Tiles
- Luxury Spa-Like Design & Feel

CURBLESS or Low-Profile Tray

Cross Section Detail

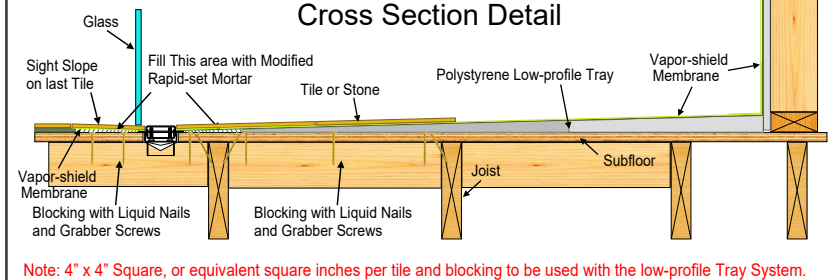

Note: 4" x 4" Square, or equivalent square inches per tile and blocking to be used with the low-profile Tray System.

The Curbless, No-Curb, Barrier-free Trend... Linear Drain Placement Design Ideas

Barrier-free Curbless Illustration Doorway Threshold

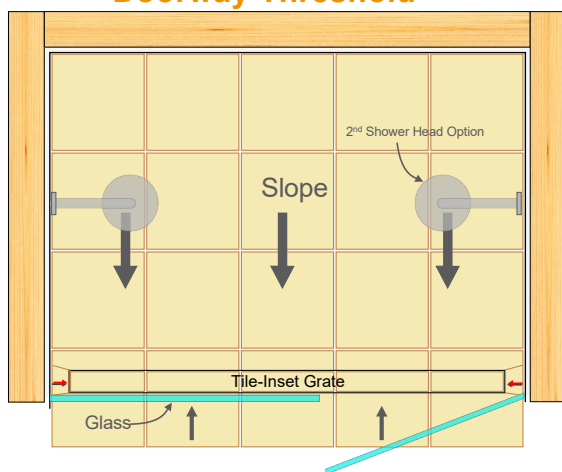

Barrier-free Curbless Illustration Doorway Threshold

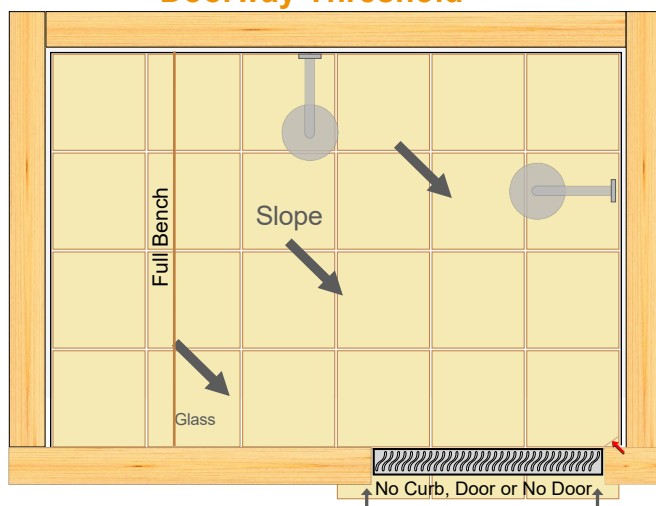

Walk-in Shower Illustration Doorway Threshold

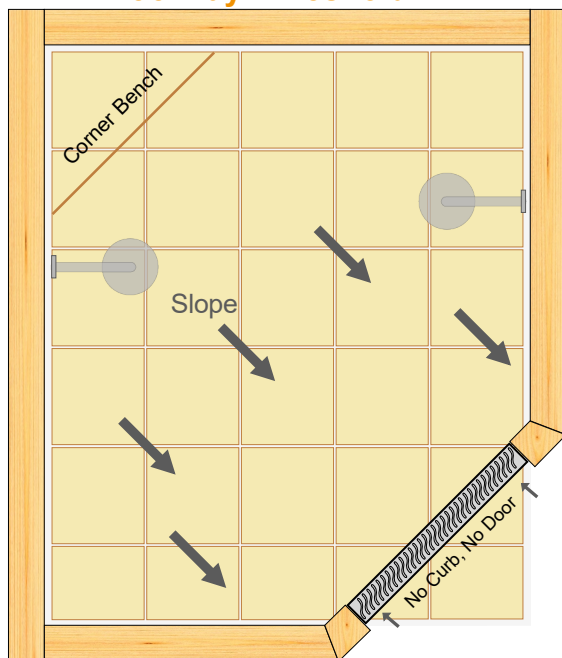

Corner Shower & Glass Illustration Doorway Threshold

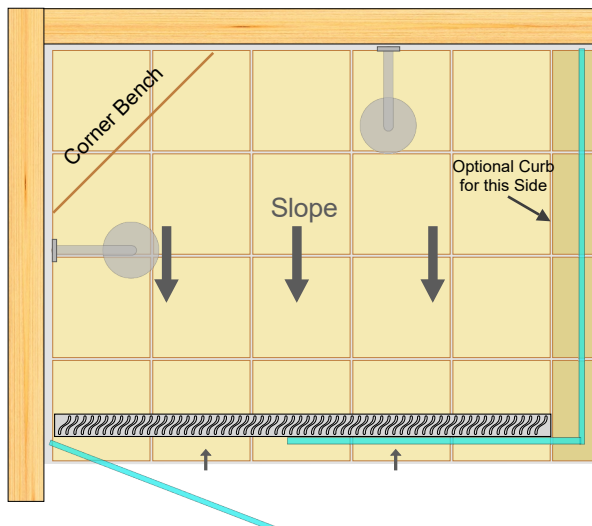

Why Curbless Trays?

- No Curb Needed
- Much Easier and Faster Install
- No Cutting of Floor Joists
- Tray Sits on existing Subfloor
- Wheel Chair Accessible
- Easy-entry for Elderly & Not So Old
- Large format Tiles
- Luxury Spa-Like Design & Feel

CURBLESS Recessed Floor

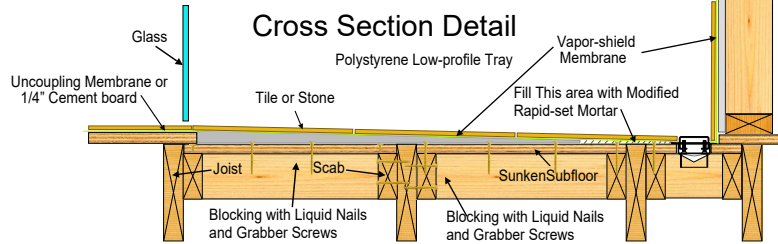

Note: 4" x 4" Square, or equivalent square inches per tile and blocking to be used with the low-profile Tray System.

The Curbless, No-Curb, Barrier-free Trend... Linear Back Wall Placement Design Ideas

The Super Shower... Trend Illustration

Back Wall Placement Example

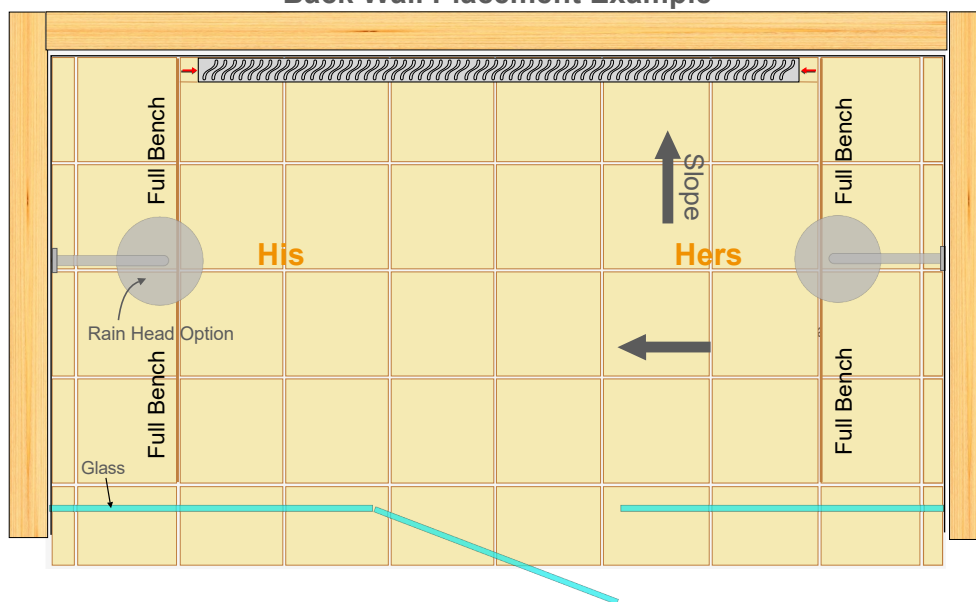

Barrier-free Curbless Recessed Floor Illustration

Back Wall Placement

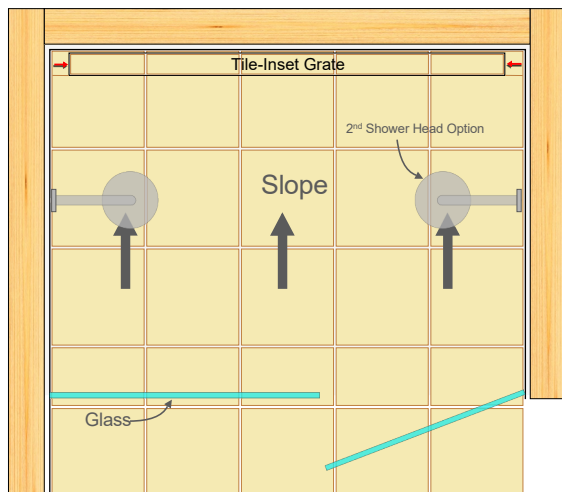

Barrier-free Curbless Recessed Floor Illustration

Back Wall Placement

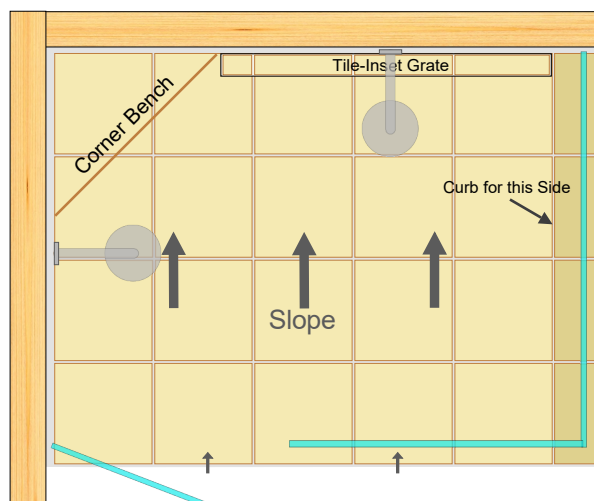

Doorway Threshold Placement

CURBLESS Recessed Floor Center Placement

Cross Section Detail

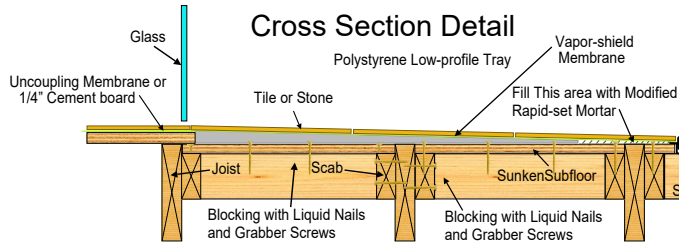

Cross Section Detail

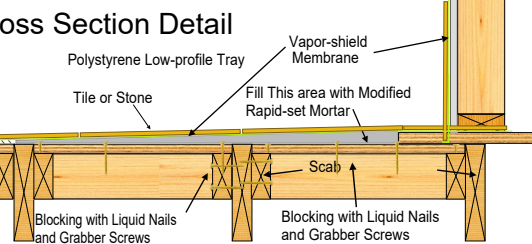

Note: 4" x 4" Square tile size, or equivalent square inches per tile and blocking to be used with the low-profile Tray System.
Note: Illustrations are not engineered construction drawings. Please consult an expert for your specific project.

The Curbless, No-Curb, Barrier-free Trend... Linear Center Placement Design Ideas

Barrier-free Curbless Recessed Floor Illustrations

Center Placement

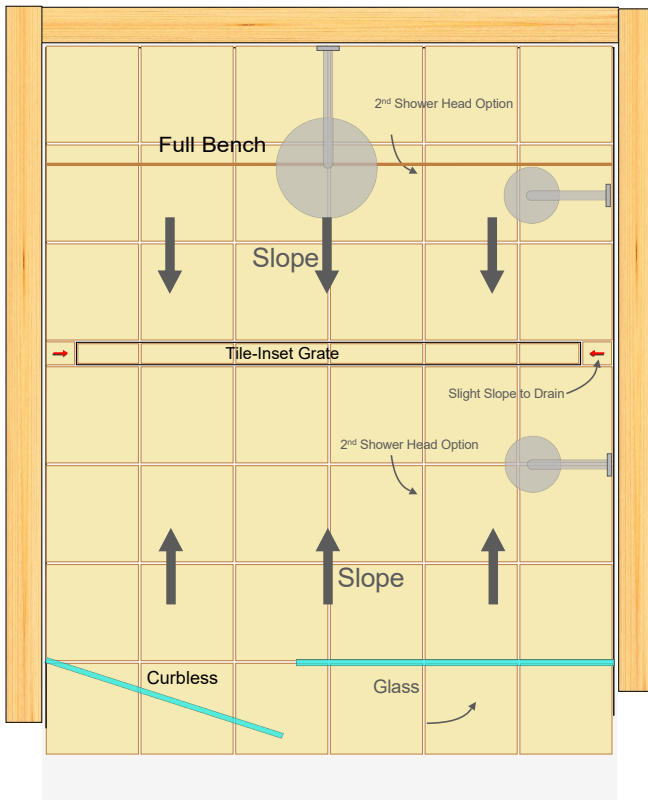

Center Placement

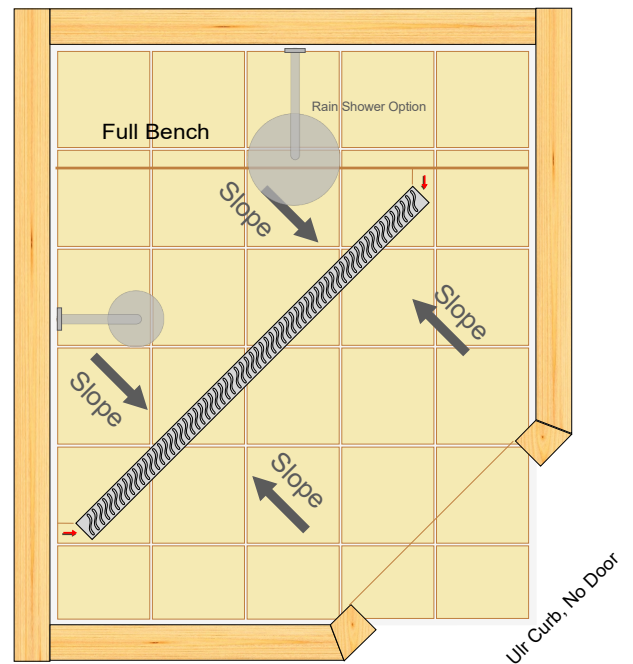

Note: Illustrations are just Ideas and not accurate construction drawing. Please consult an expert for you specific project.

Fastest & Easiest Barrier-Free Shower System

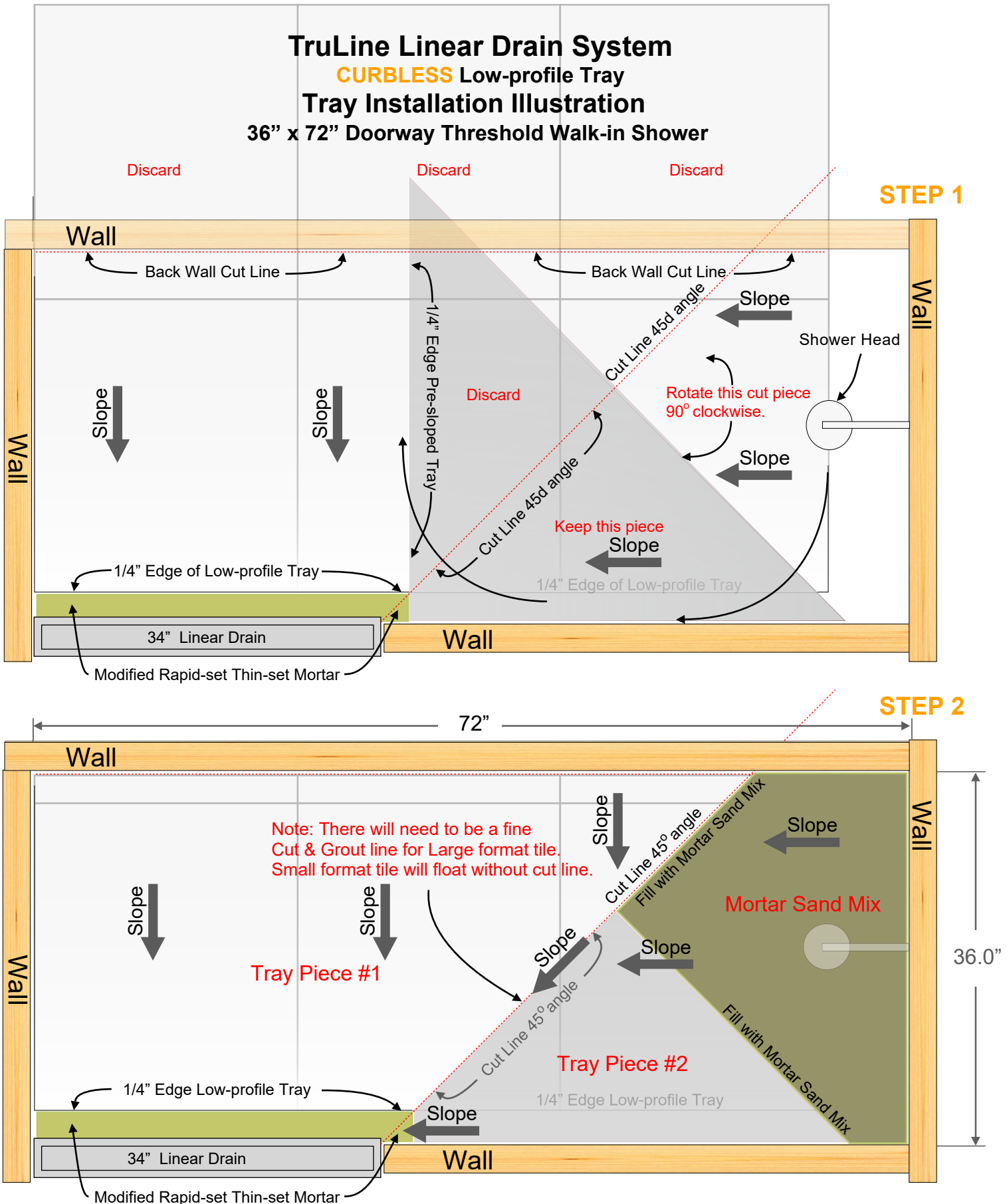

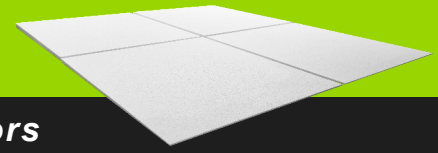

Angle Positioning of the Low-profile Curb-free Tray

CURBLESS No Door Walk-in Illustration

S-Style Grate

Illustrated Shower Size: 60"x 69"

45 Degree Tray trimming Illustration

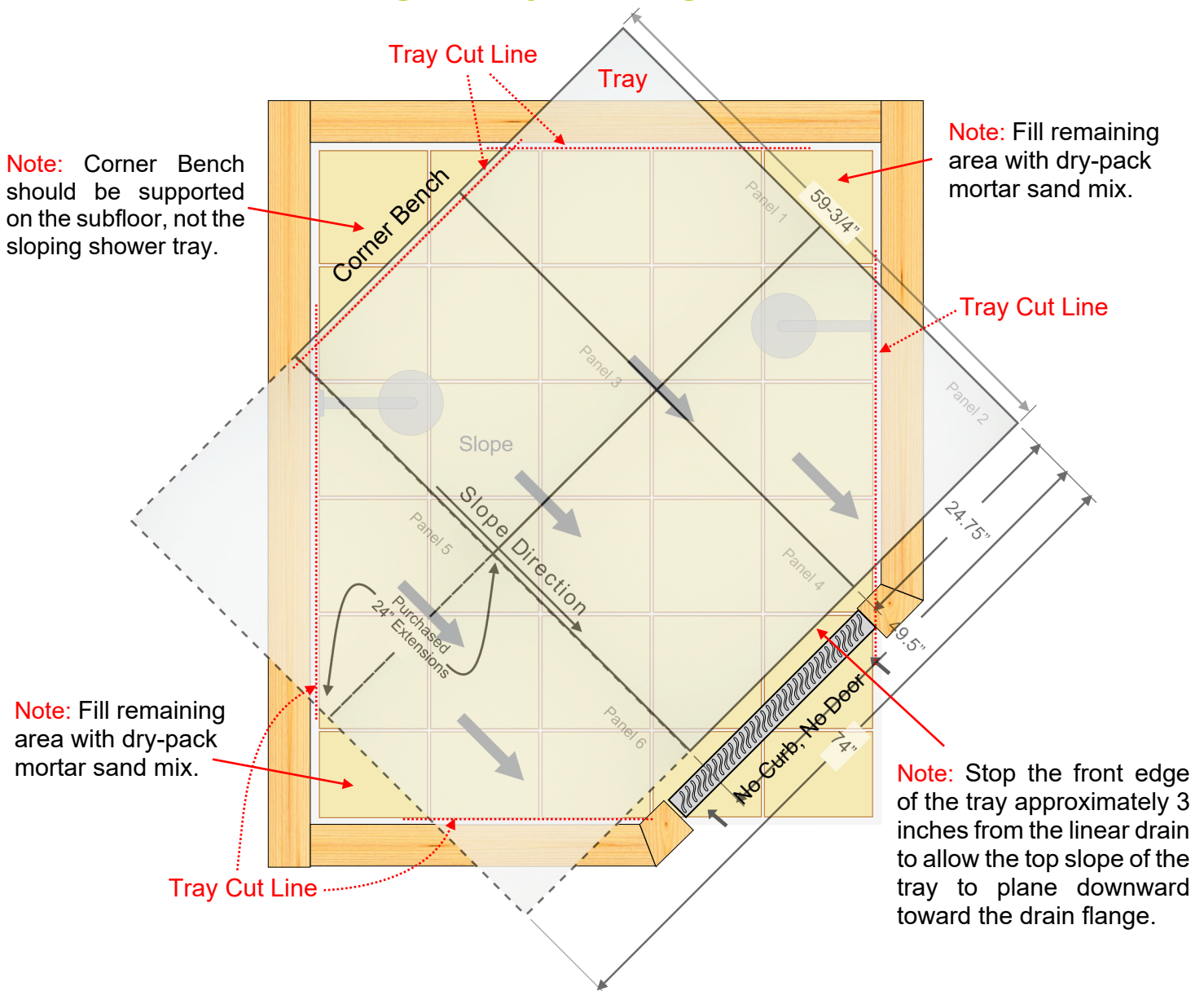

Note: For wood floors, add a layer of 1/4" cement backer-board on top of the low-profile tray for tile format sizes smaller than 4" x 4" format.

Note: Block support the subfloor around where the linear drain trench whole was cut into the subfloor and under the shower subfloor where needed for structural support. Consult a structural engineer if needed.

Standard Linear Drain Shower Tray, with Curb

TruCurb 4.5" x 5" x 36"
Polystyrene Shower Curb

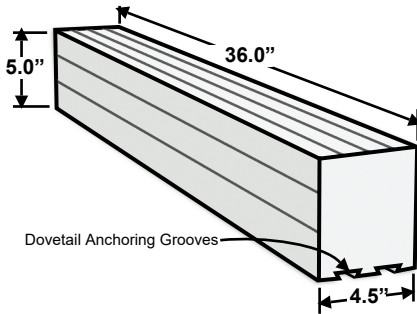

TruCurb 4.5" x 5" x 48" or 60"
Polystyrene Shower Curb

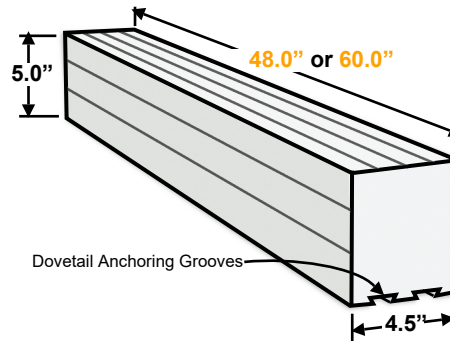

TruCurb 4.5" x 5" x 72"
(Two - 4.5" x 5" x 36" Curbs)
Polystyrene Shower Curb

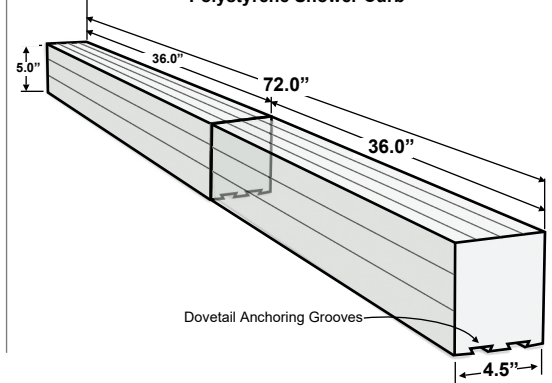

Standard Tray, Linear Drain with Curb Doorway LARGE Shower or Steam Room Example

Note: Large or Unique shaped shower may require Dry-pack sand mix mortar to complete the sloped floor area.

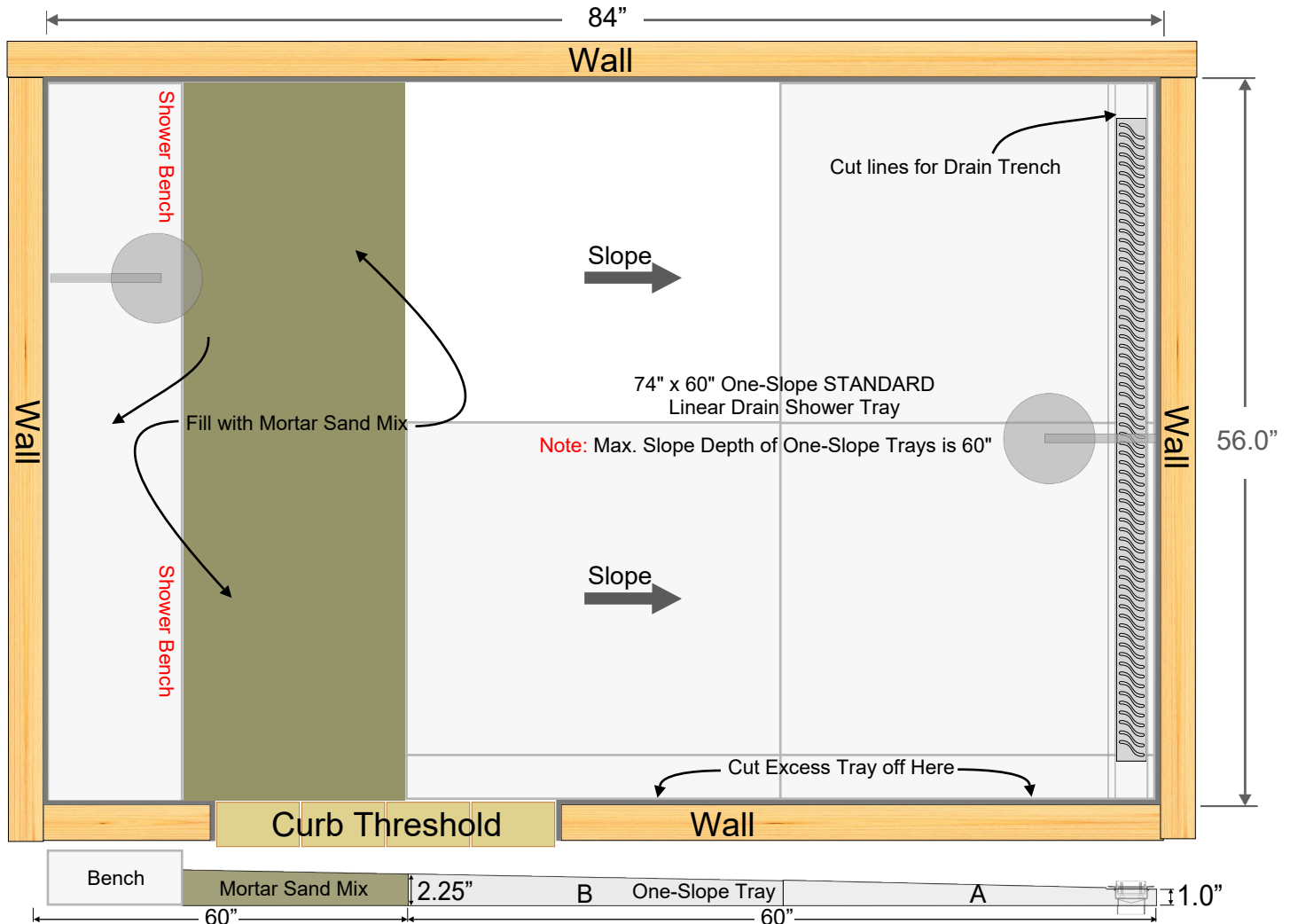

TruSlope Low-profile Tray... The Easiest & Fastest Barrier-free system period!

Standard One-slope Trays Cross Section

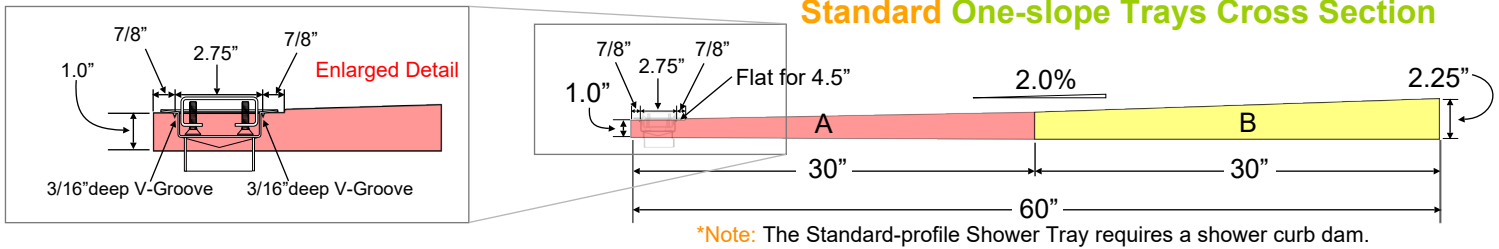

Plumbing Wall Placement Example

Tile-inset Grate Style

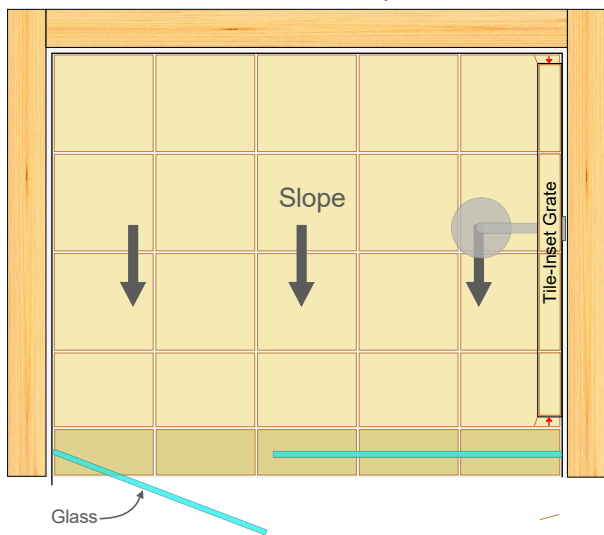

Doorway with Curb Example

S-Style Grate

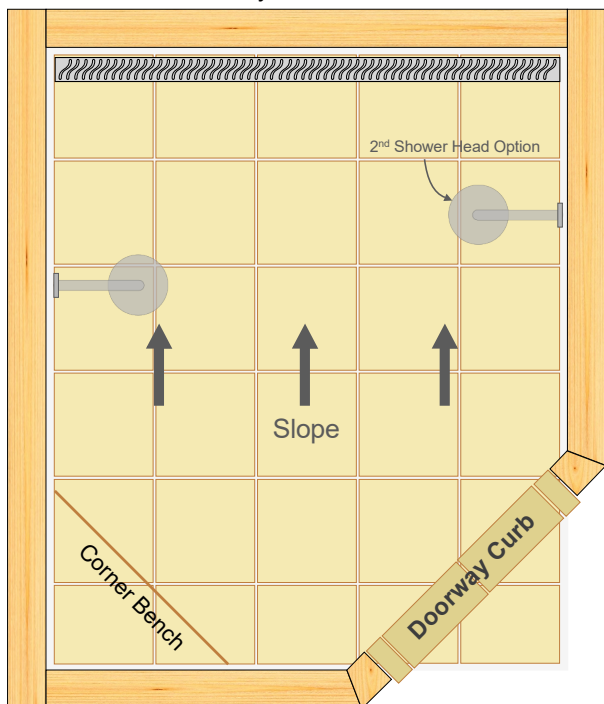

Back Wall Placement Example

S-Style Grate

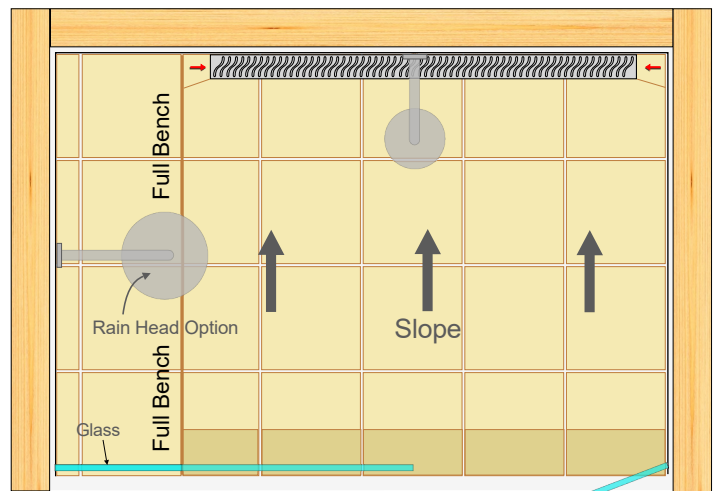

Corner Shower with Curb & Glass Example

S-Style Grate

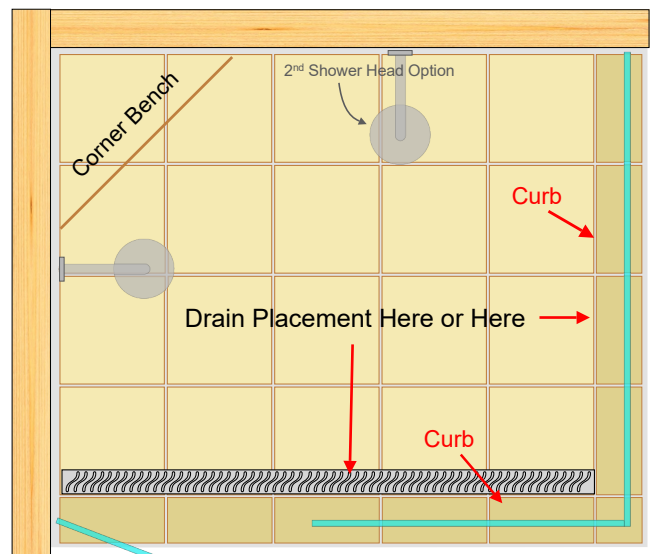

Doorway Threshold Placement

Standard Linear Drain Tray, with Curb

Standard One-slope Trays Cross Section

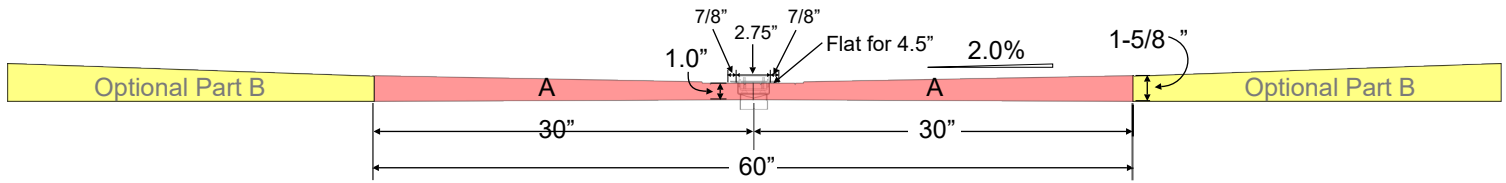

Super Shower Trend Center Placement Example

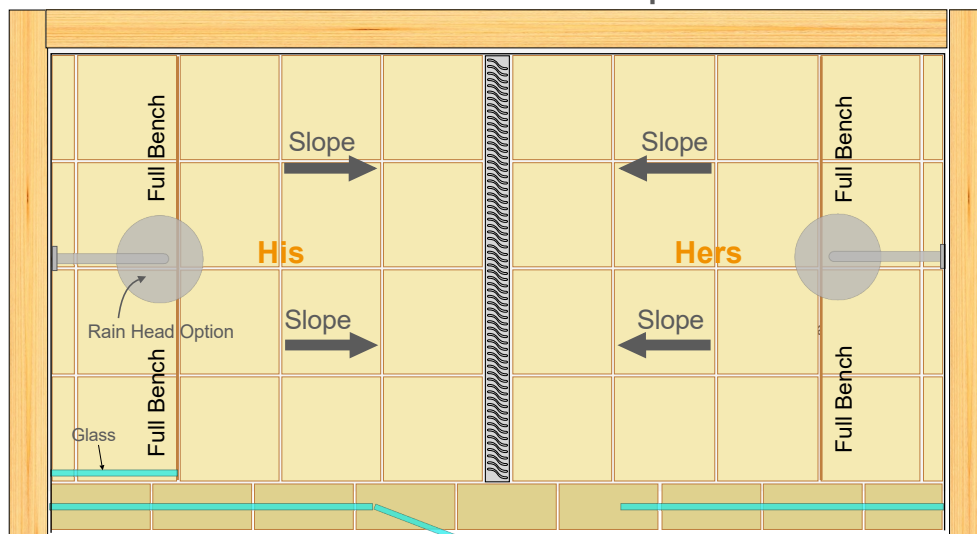

Doorway Shower Center Placement

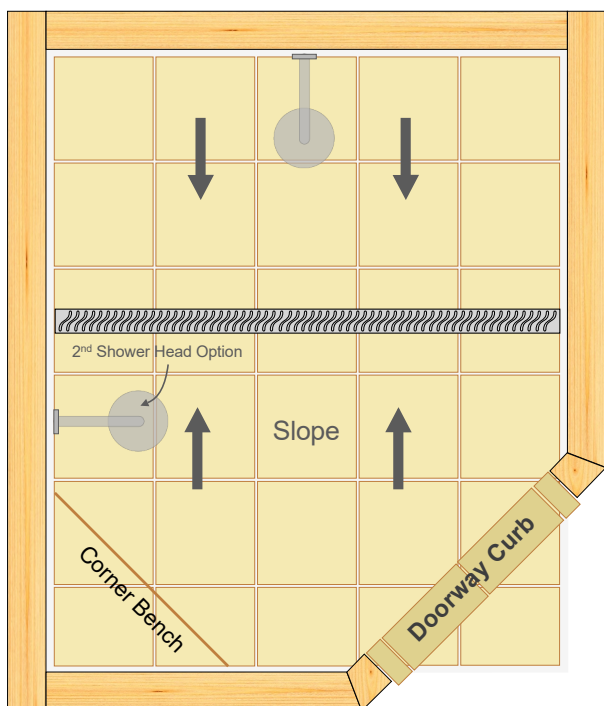

Corner Shower Center Placement Corner Shower with Curb & Glass Example

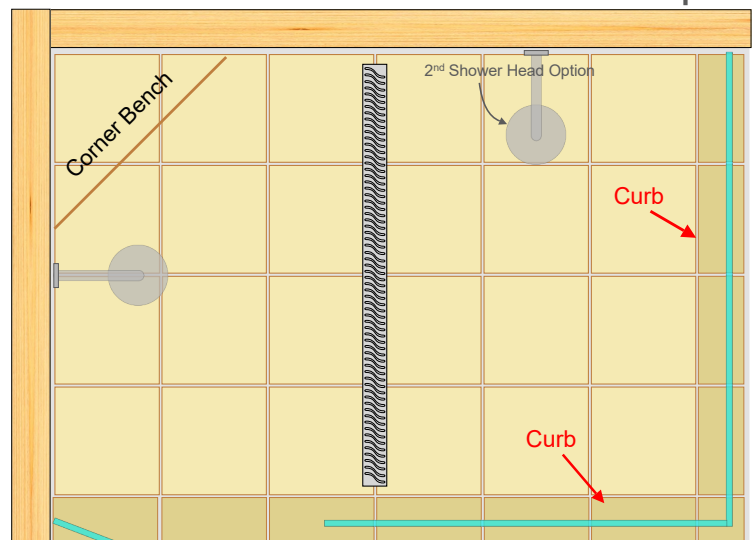

Doorway Threshold Placement

What if my Linear Drain is not full length?

- Small cuts and a slight slope is all that is required so as to have no puddling. Often at the end of the drain, a side tile only has from 1/16" to 1/8" total slope.
- Sometime, it is possible to create enough slope at the wall to floor intersection with the poly-grout caulk. (See the detail diagram below)

Why the Large Format Tile Trend?

- Less grout line equals Less Maintenance
- Continued tile pattern from the Bathroom into the Shower
- Luxury Commercial Spa Atmosphere
- Less busy Design for Relaxation
- New and Different updated Design

Linear Drain "Not to Full Length" Detailed Illustrations Tips & Tricks

Doorway Threshold Placement

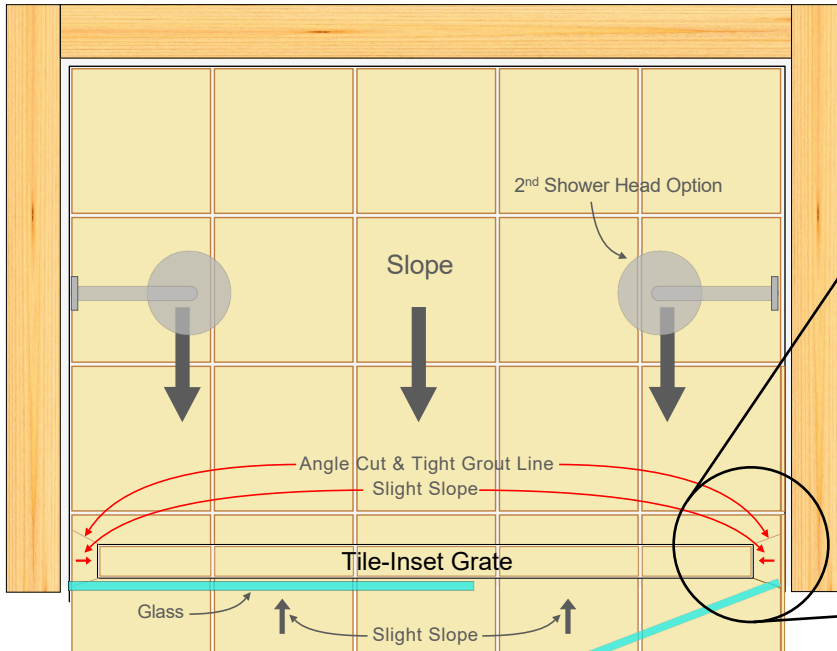

Curbless Illustration

Doorway Threshold Placement

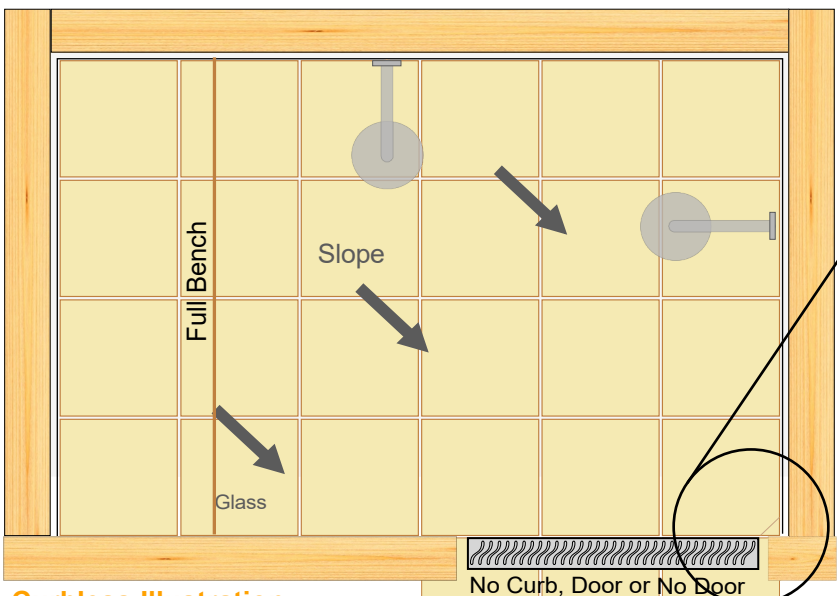

Curbless Illustration

Note: Illustrations are not engineered construction drawings. Please consult an expert for you specific project.

Less grout lines equals Less Maintenance... Yes, that is good!

Note: Low-profile Trays may require additional floor stiffening support components. See illustrated possible options below.

CURBLESS Low-profile Tray with Large Format Tile

Doorway Threshold Linear Drain Placement

Cross Section Detail

Large Format Tile Illustration

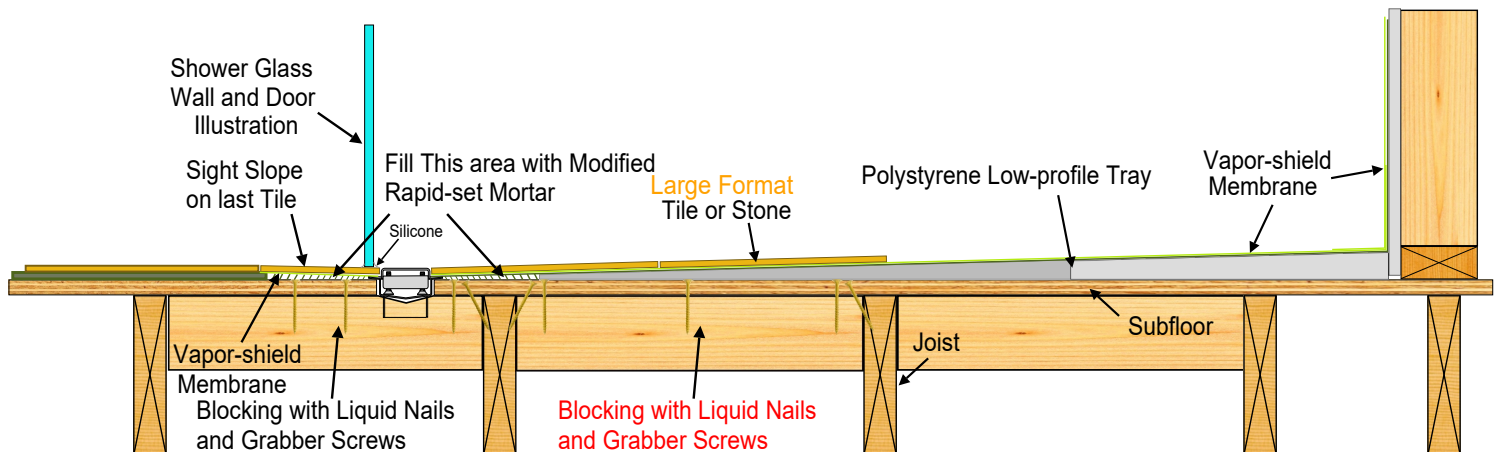

Note: 4" x 4" Square, or approximate square inches per tile and blocking to be used with the low-profile tray system to ensure a solid floor and subfloor. No small format Mosaic or pebble type tiles to be applied directly on Polystyrene or follow the 1/4" cement or Hardi board option as illustrated below.

Note: Maximum allowable deflection is: L/360 tile L/720 stone. See TCNA F150-13 tile installations, TCNA F141-13 and F250-13 for stone.(TCNA) Tile Council of North America. In Simple terms, a single layer of 3/4" subfloor may not adequate support and must be stiffened in order for tile to have a long lasting life-span. The Low-profile tray does not have adequate bridging affect until it is approximately 1" thick or greater.

CURBLESS Tray with Mosaic or Pebble

Doorway Threshold Linear Drain Placement

Cross Section Detail

Small Format Tile Illustration

Cement Board Required

for Tiles less than the 4" x 4" Square

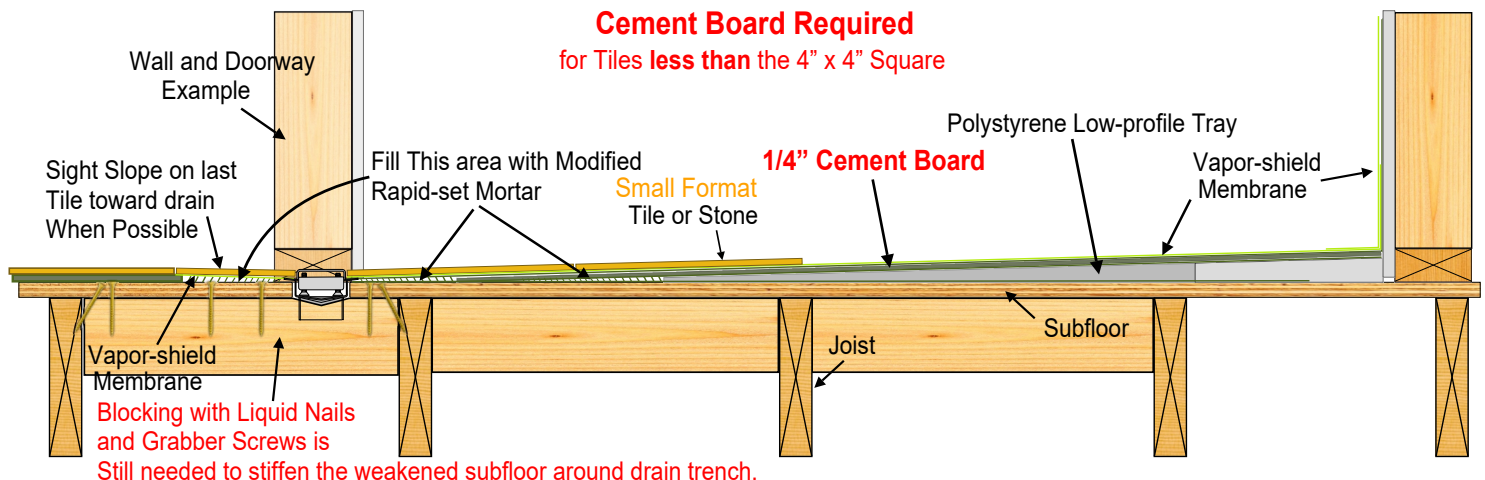

Note: Smaller format tiles less than the 4" x 4" Square, or approximate square inches per tile may be used with the cement backer board option.

Note: Maximum allowable deflection is: L/360 tile L/720 stone. See TCNA F150-13 tile installations, TCNA F141-13 and F250-13 for stone.(TCNA) Tile Council of North America. In Simple terms, a single layer of 3/4" subfloor is not adequate support and must be stiffened to not be bouncy in order for tile to have a long lasting life installation. The Low-profile tray does not have adequate bridging affect until it is approximately 1" thick or greater.

CURBLESS Linear Drain Tray

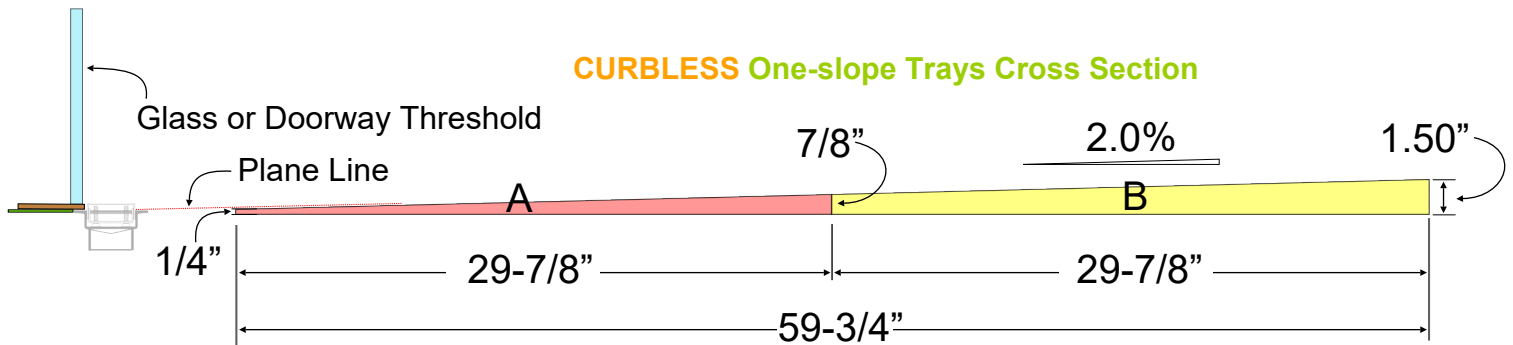

Zoomed-in Detail

CURBLESS or Low-profile Tray

Doorway Threshold Placement Cross Section Detail

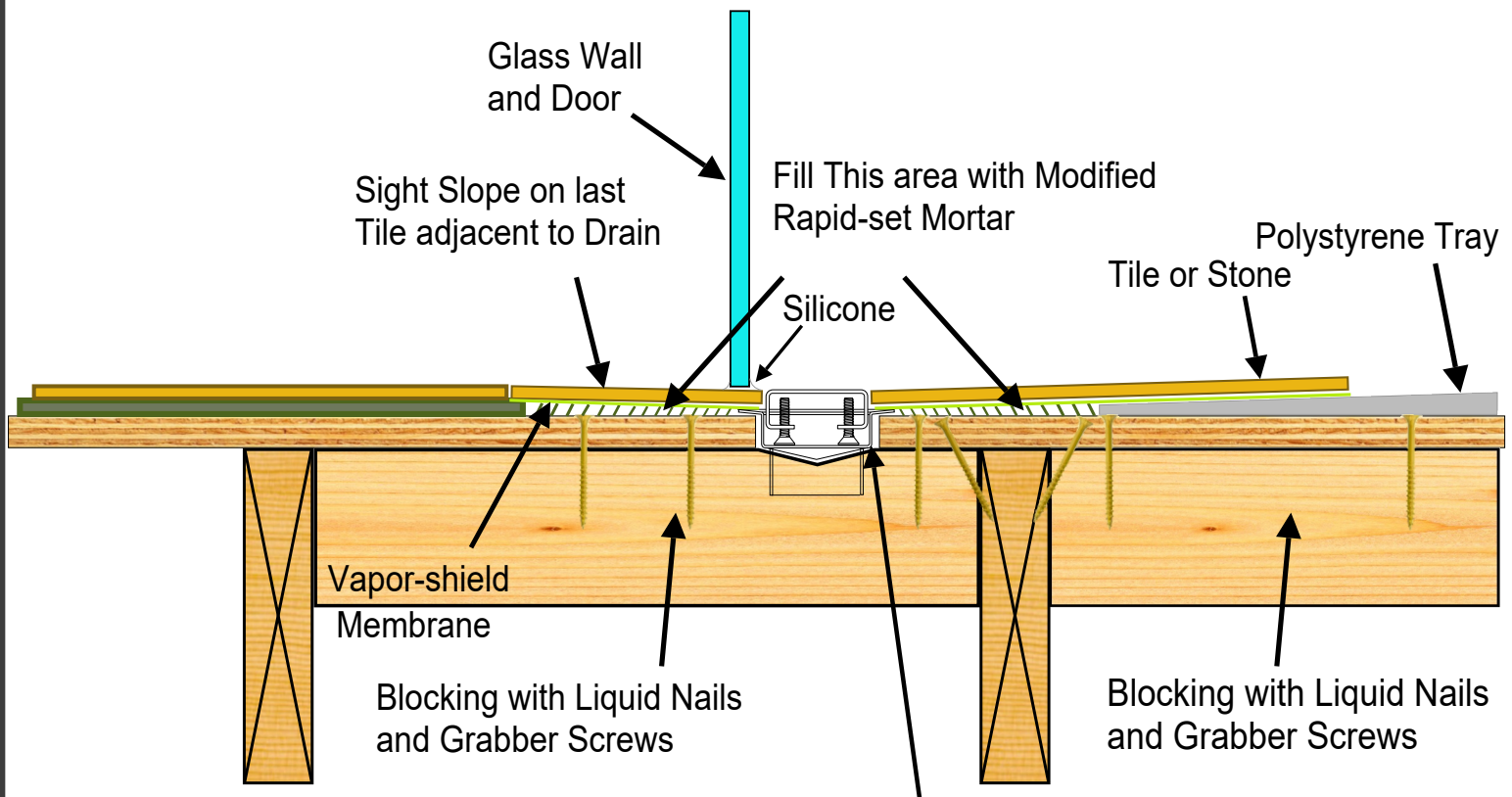

Note: The Trench goes down into the subfloor area while the Drain flanges sit on the subfloor.

Note: When you cut into the subfloor, it will always require blocking to support and stiffen up the subfloor around the drain area.



TRU-LINE LINEAR DRAIN - Layers Illustration for Wood Floor Installation

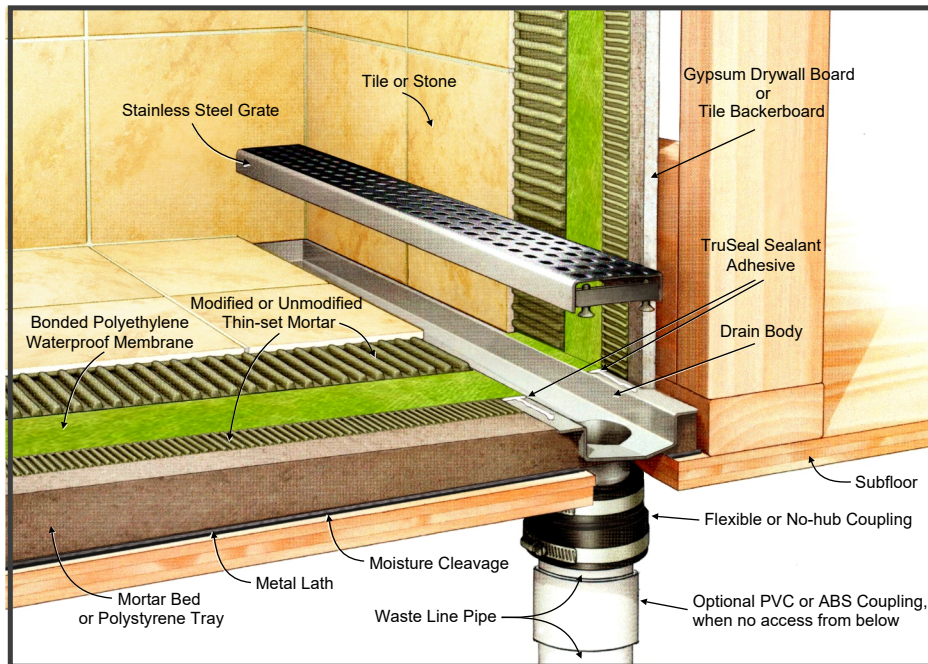

Layer View of Linear Drain Assembly Components

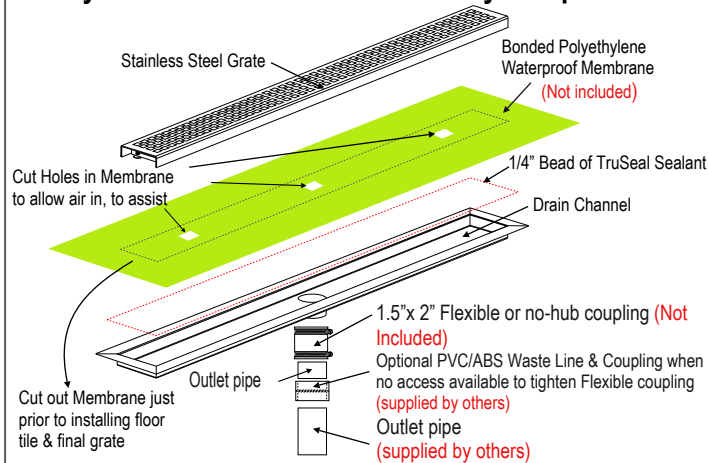

Wall Placement Detail

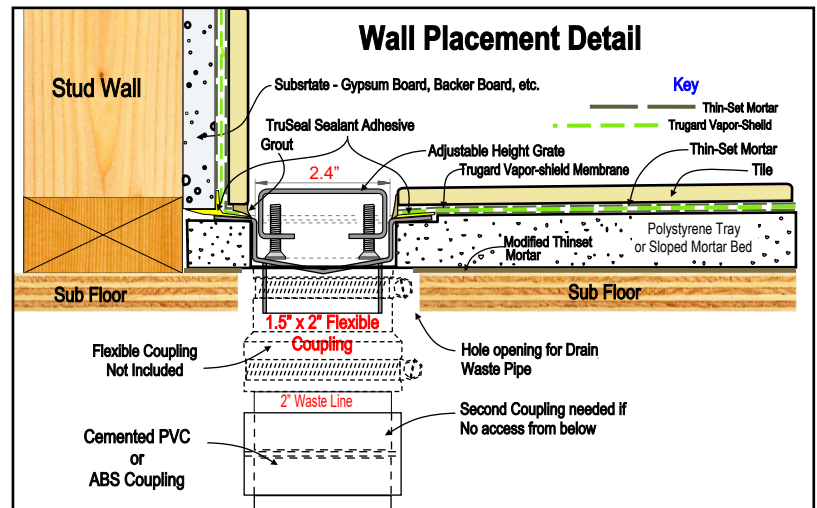

Wall Placement Detail

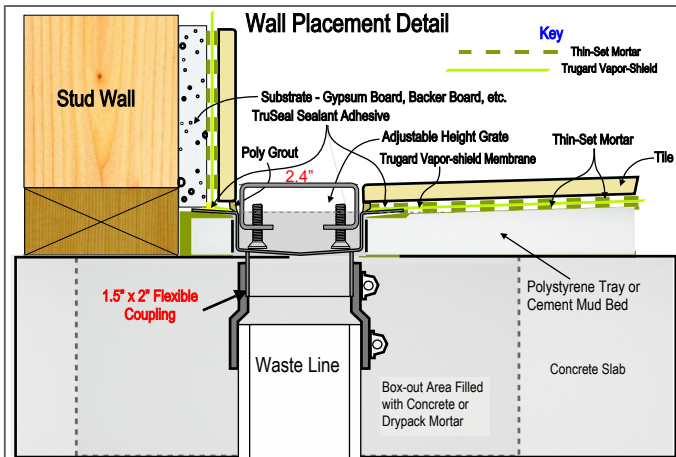

Intermediate Placement

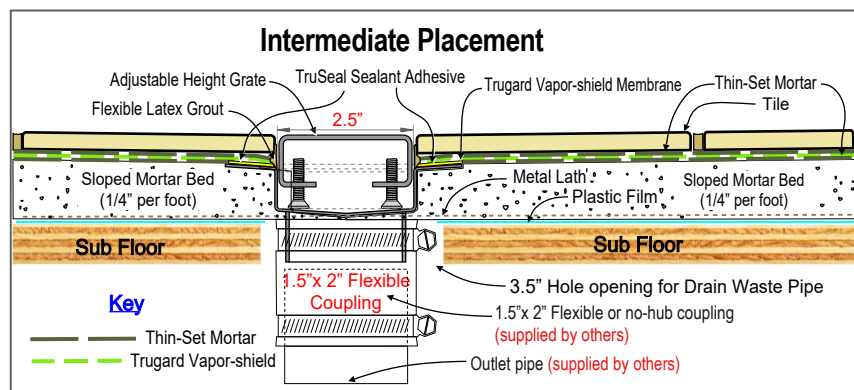

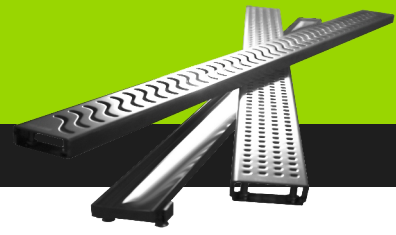

TRU-LINE LINEAR DRAIN - Layers Illustration for Slab Floor Installation

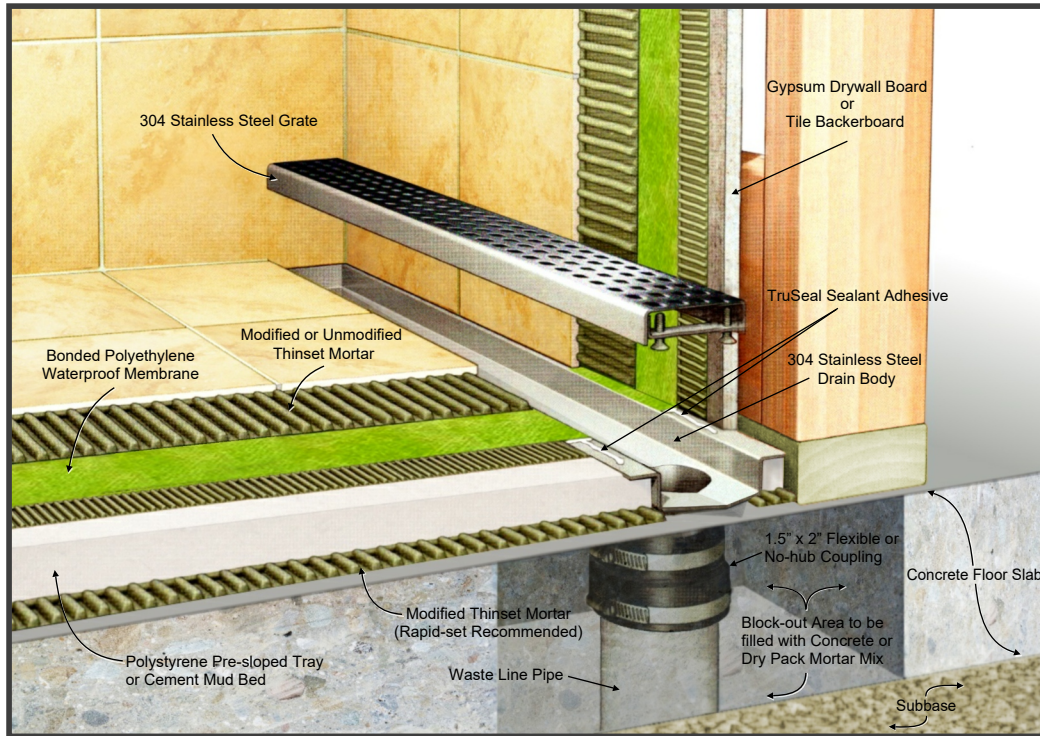

1 Slab Block-out Illustration STANDARD Tray with Curb Option

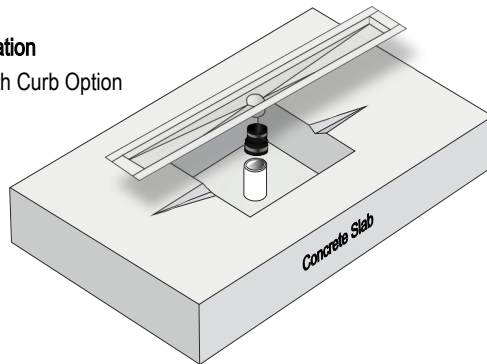

2 CURBLESS Block-out or Cut-out Illustration Low-profile Tray Option

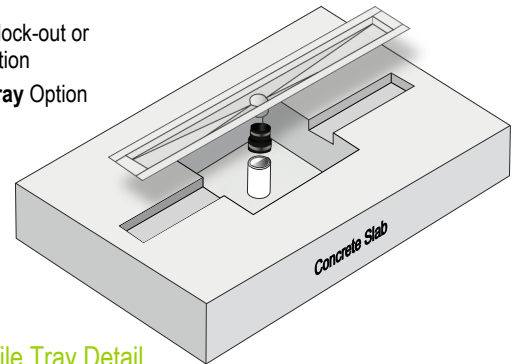

Standard Tray Detail

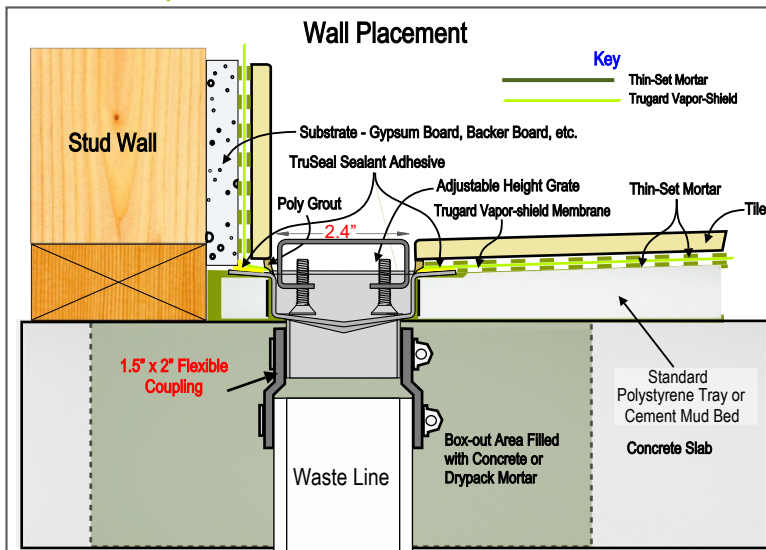

Curbless Low-profile Tray Detail

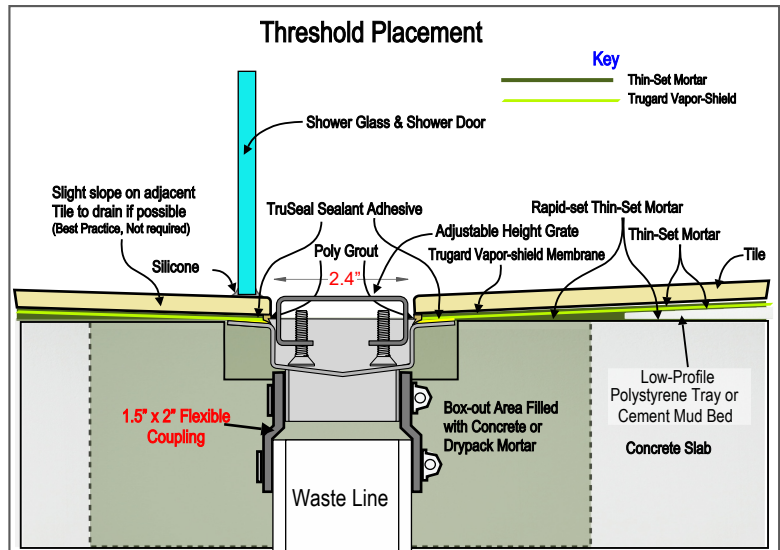

One-slope STANDARD profile Shower Floor Tray

Designed specifically for Linear Shower Drains

Standard-Profile Sizes: 49.5" x 60" or 49.5" x 74"

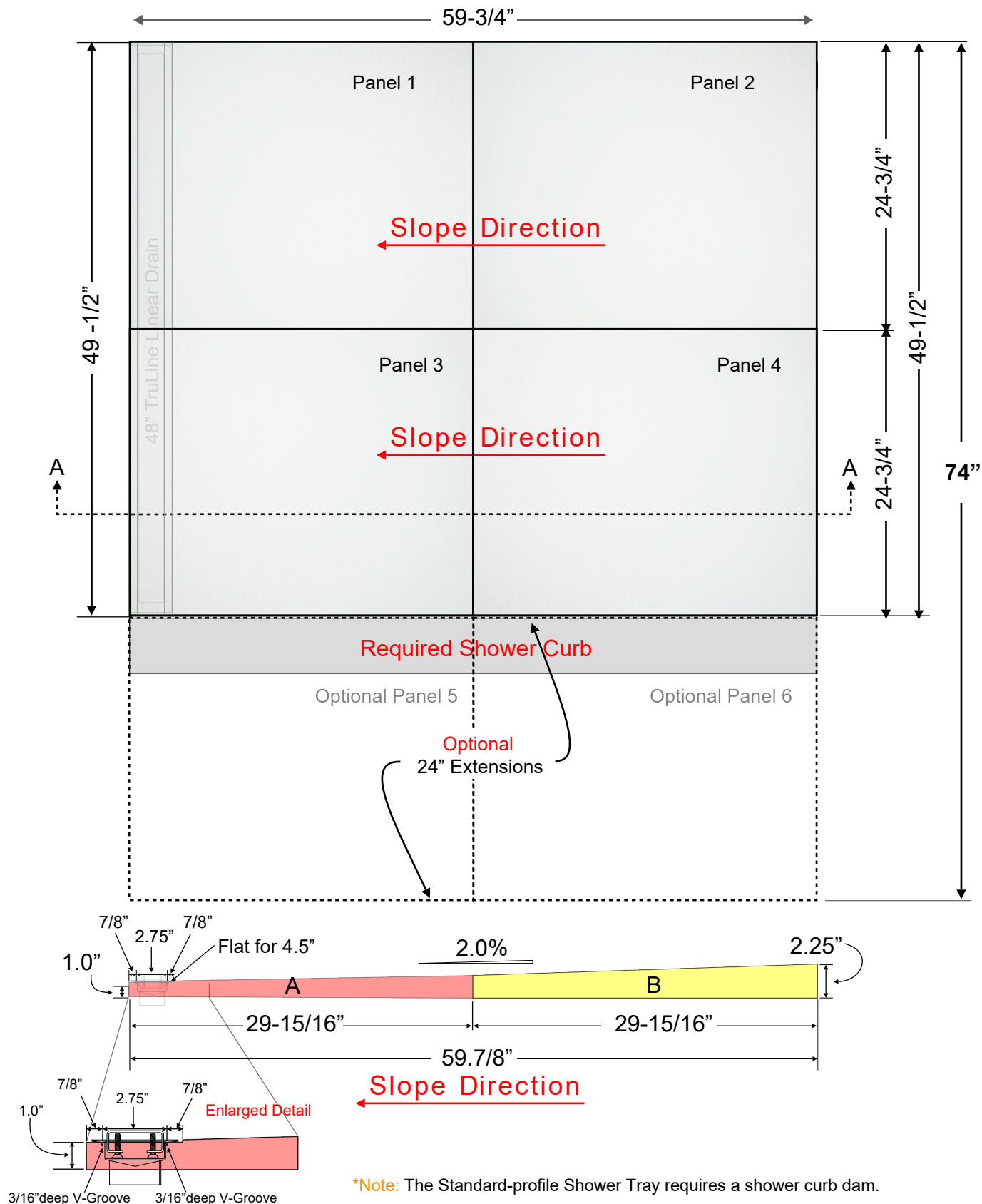

Oasi's one-slope low-profile shower trays are made of high density lightweight expanded polystyrene for constructing mortar-bed free showers. Specifically designed to integrate with Oasi® TruLine Linear drains, and the Trugard® Vapor-shield or Steam-shield waterproofing membrane system.

One-slope CURBLESS Low-profile Shower Floor Tray

Designed specifically for Linear Shower Drains

Low-Profile Sizes: 49.5" x 60" or 49.5" x 74"

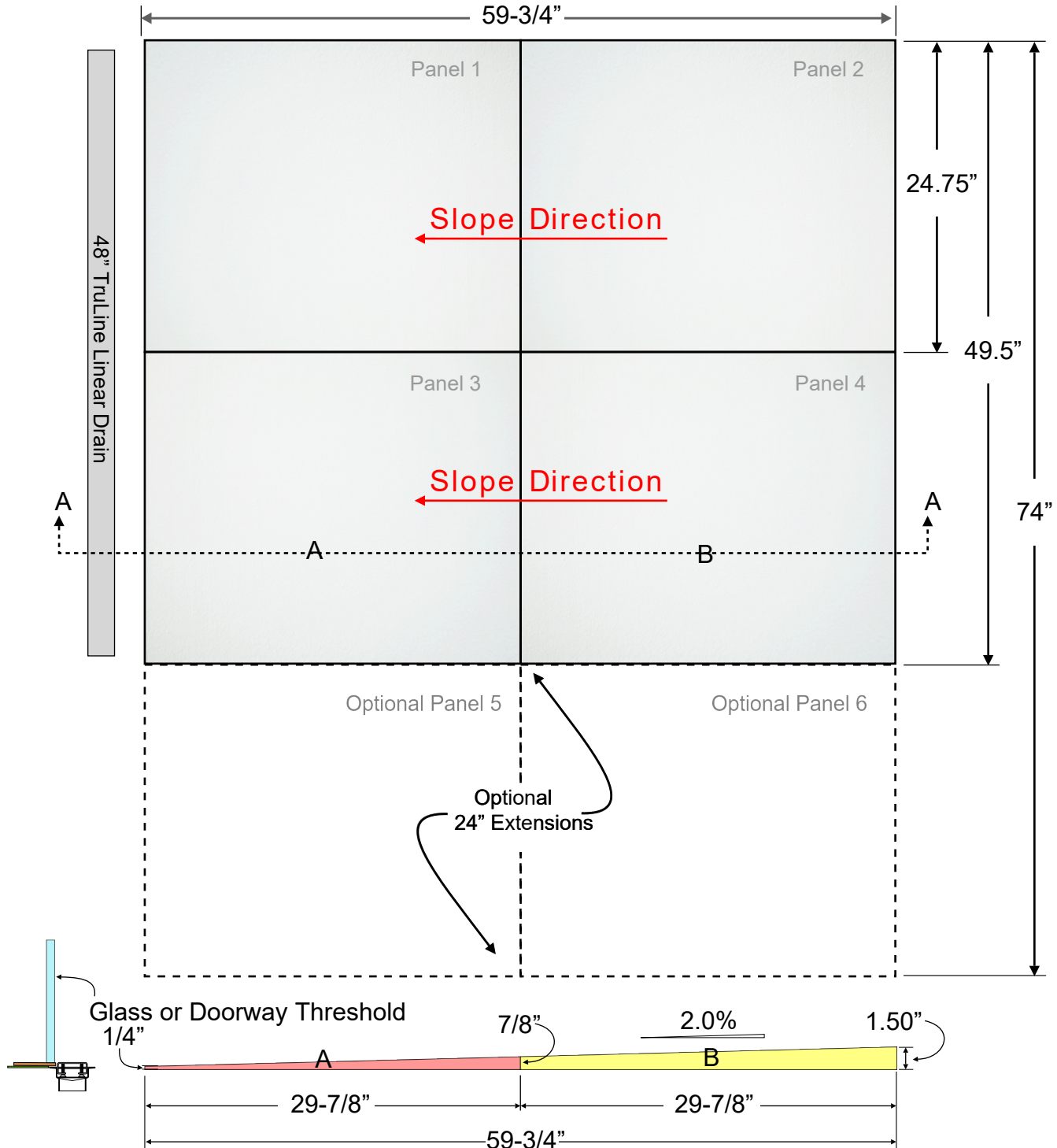

***Note:** The 49.5"x 60" Shower Tray requires is best suited to fit up to the 48" linear drain, and the 42" linear drain is acceptable.

Make it leak proof... Faster & Easier!



- 1** **1a. Pre-fit the shower tray** by measuring then cutting the tray to fit the desired placement.
1b. For standard trays, place the linear drain onto its side marking the trench length then cutting out the "trench cut-out area" so that the drain trench sits down into the tray and the drain flanges sit on top of the tray.



- 2** For **Low-profile trays**, cut a rectangular hole into the floor substrate in the desired drain location to allow the linear drain trench to snugly fit down into the floor substrate, with the drain flanges being supported by the floor substrate.



- 3** **3a. Apply modified or unmodified thin-set mortar** to the substrate using a 1/4" x 3/8" square-notched trowel.
3b. Place the TruSlope shower tray onto the thin-set mortar.
3c. Use TruSeal Sealant Adhesive or thin-set mortar to bond the butt joints of the tray pieces together.
Note: The sub-floor must be level. Leveling must be done prior to placing the tray.



- 4** **4a. Embed the tray** into the mortar by firmly walking on the TruSlope tray.
Note: Low-profile trays require an approximate 3/4" x 2ft. x 2ft. plywood or similar flat object to ensure even embedding of the thin part of the tray.
4b. Lift and check the underside of the **Standard tray only (not Low-profile trays)**, to ensure complete coverage is achieved, then repeat step 4a for **standard** One-slope trays.

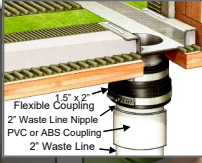

- 5** **Install the Trugard Drain** by generously applying modified or unmodified thin-set mortar and embedding TruLine linear drain into the thin-set mortar.
Note: If there is no access from below use a PVC pipe nipple and cement glue coupling to connect the plumbing waste line while simultaneously embedding the drain. (See above illustration)
- 6** If a TruCurb will be used, **Pre-fit the TruCurb** by measuring and cutting the curb to length using a standard handsaw.
Note: Curb-free showers generally use Low-profile trays and need no curb, while standard one-slope trays generally always require a curb.



- 9** Now you are ready to **Apply Trugard Vapor-shield or Steam-shield with modified thin-set or premium quality unmodified thin-set mortar** to the TruSlope tray substrate using a 1/8" x 1/8" square notched trowel or 1/4" x 3/16" V-notched trowel as described in the Trugard Vapor-shield instruction handbook.

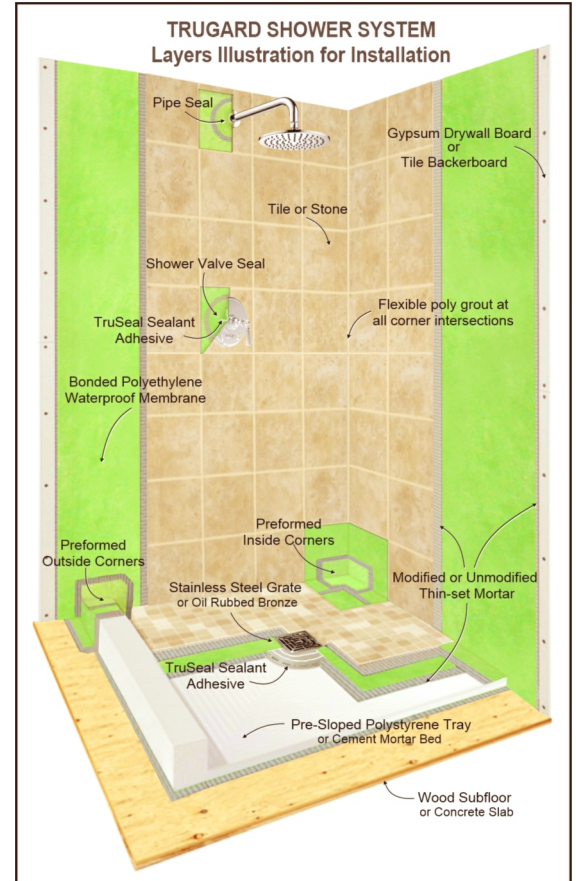

Note: Modified Rapidset or Speedset thin-set mortar is recommended for the setting of the TruCurb for a quicker cure time. (Not required)

Modified thin-set mortar is recommended for use over gypsum board and cement backerboard substrates. Also **Modified thin-set mortar** is recommended over the Vapor-shield membrane for tile installation. (One popular brand we recommend is **VersaBond** from Home Depot.)

Premium quality unmodified thin-set mortar is also approved and may be used if desired.

Congratulations! Your TruSlope Tray and TruCurb shower dam is installed!