

Note: These instructions are based on wood floors, wall placement of the drain and a one-slope traditional mortar bed System.

1 Choose Shower Drain Placement

Placement of the OASI Truline® linear shower drain is ideally at an end wall, the threshold of a doorway or somewhere in the middle of the shower or steam room floor.

End Wall Placement

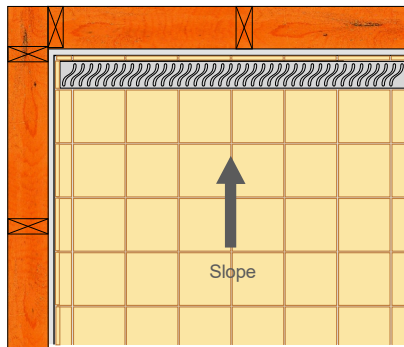

Doorway Threshold Placement

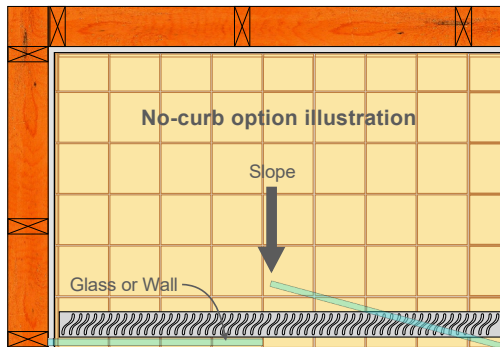

Intermediate Placement

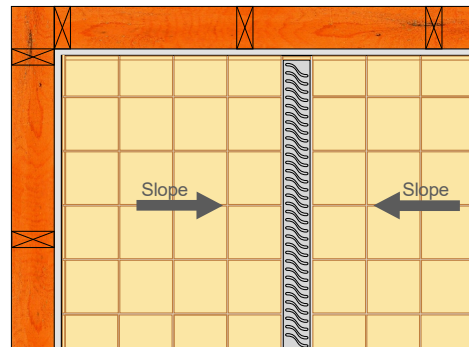

2 Locate Waste Drain Pipework

Re-locate rough-in pipework if necessary to align with desired placement of linear drain.

3 Locate and Cut out Drain Hole

Locate, mark drain location and cut a 3 1/2 inch hole. Center of waste drain line is often located 2 1/4 inches from the wall sill plate. More precisely locate placement by, adding the thickness of the wall substrate, Plus 1/4 inch for the waterproof polyethylene membrane and thin-set assembly, Plus the thickness of the tile or stone. The wall side of the Truline drain body/trough should end up flush with the face of the tile or stone.

4 Pre-fit the Linear Drain

Next, pre-fit the linear drain to the plumbing waste line to ensure correct placement of the drain. If drain placement is correct, remove drain body.

5 Install Moisture Cleavage

Prepare to install the mortar bed by first installing a moisture barrier cleavage over the wood shower floor area.

Note: For concrete slab installation, wet the slab and apply the mortar mix directly onto the slab.

6 Install Metal Lath

Install metal lath over the shower floor cleavage in accordance with local building codes.

7 Protect the Drain Body & Flange

Apply painters masking tape or clear packing tape to the top of the drain flanges and body to protect and keep the inside drain body trough and flanges clean from mortar and debris.

8 Build the Drain Body Support

Now prepare a slightly wetter than normal mortar bed sand mix, and build a support base under the linear drain trench, and the flanges of the two ends and back flange closest to the wall.

9 Install & Connect the Drain Body

Install the Truline drain body by connecting the drain outlet to the plumbing waste line using a flexible or no-hub coupling, and by squishing the drain body down into the, wetter than normal, mortar bed mix.

Note: Figure or image 3 corresponds to text Step # 3

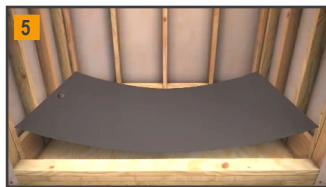
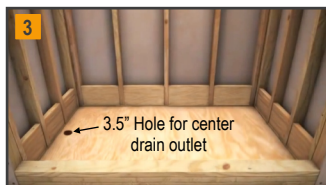

10 Level the Drain

Next level the drain body and pack mortar under the remaining drain flange.

11 Establish Mortar bed Grade Height

Now establish the grade height including a 2% or 1/4 inch per foot slope toward the drain. Use a chalk-line or pencil and straight edge to create lines on the walls.

12 Build a Mortar Perimeter Guide

Build a mortar perimeter around the floor edges to the height of the grade lines.

13 Complete Mortar Bed

Use the perimeter mortar as guides filling in and compacting in the entire mortar bed floor area, maintaining the 1/4 inch per 1 foot slope toward the drain.

14 Install the Wall Substrate

Install the wall substrate in accordance with local code requirements, which generally requires cementitious backer board or gypsum "drywall" board.

Note: Trugard Vapor-shield works on standard, green or purple types of drywall.

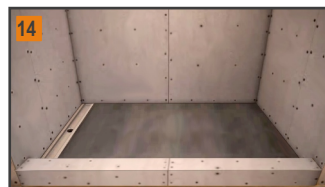
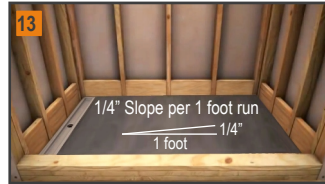

TRU-LINE LINEAR DRAIN - Layers Illustration for Installation on Wood Floors with Mortar Bed

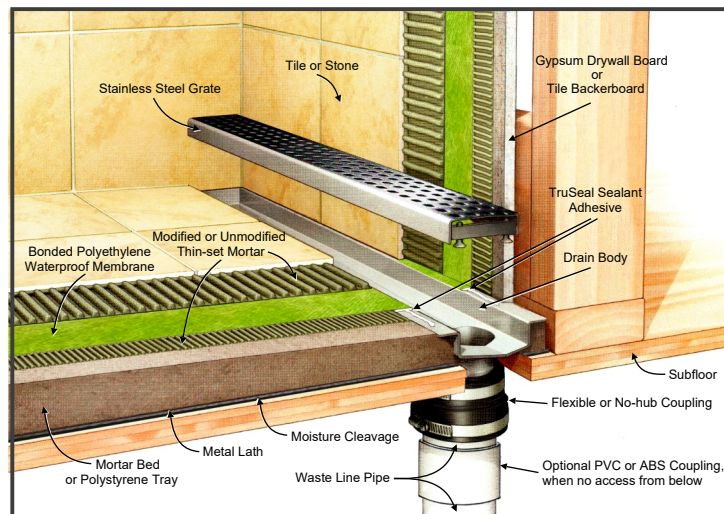

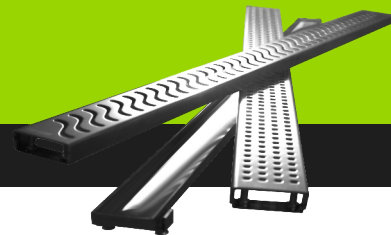

Note: Instructions are based on wood floors, wall placement of drain and a one-slope traditional mortar bed System.

15 Install Polyethylene Waterproof Membrane

Now install the Trugard bonded polyethylene waterproof membrane in accordance with Trugard Systems' approved installation instructions.

15.1 Apply Thin-set to Floor Area

Apply Modified or Unmodified thin-set mortar to the floor area from the outer edge of the drain bonding flange outward. For wall placement, 6 inches up the wall adjacent to the drain. **Note: Do Not apply thin-set to the stainless steel drain flange.**

15.2 Apply TruSeal Sealant to Drain Flange

Now, remove the previously applied tape from the drain body and flanges. Apply **one** 1/4" bead of TruSeal sealant around the drain flange, and install floor Vapor-shield membrane.

15.3 Place and Embed Membrane into Sealant

Place membrane onto floor area. Now press down the Vapor-shield membrane squeezing the sealant sideways along the drain flange to completely cover the stainless steel flange, and then embed the membrane into the thin-set mortar in an outward direction towards the perimeter of the shower floor.

15.4 "Tile-in" Style Grate - Instructions

For the Truline "Tile-in" grate style, modified or unmodified thin-set mortar may be used to set the tile in the grate. Back butter all four sides of the inside of the "Tile-in" grate, as the lip on the inside perimeter is designed to hold the tile in the grate.

16 Install the Tile

Install the tile using best industry practices, **starting on the wall adjacent to the drain**. After completing the first row of wall tile, temporarily install the drain grate to ensure that the drain grate can be inserted and removed freely with approximately 1/16 to 1/8 inch of clearance. Complete tile installation.

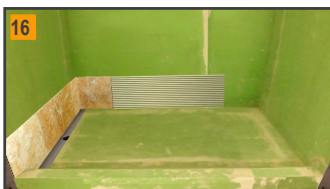

17 Grout the Tile

After 24 hours of drying and curing of the thin-set mortar, grouting of the tile may be completed, using industry best practices.

17.1 Use flexible tile grout caulk to grout the "tile-in" grate tiles.

17.2 Use flexible tile grout caulk to grout all wall to wall and floor to wall intersections.

18 Caulk around Tile Perimeter

Hint: to give your tile job a professional looking installation, use painters masking tape as a straight edge around the perimeter of the tile job, and apply the flexible grout caulk. Remove tape.



For more info, Videos,
Detailed Drawings & more
Visit
TrugardDirect.com

Layer View of Linear Drain Assembly Components

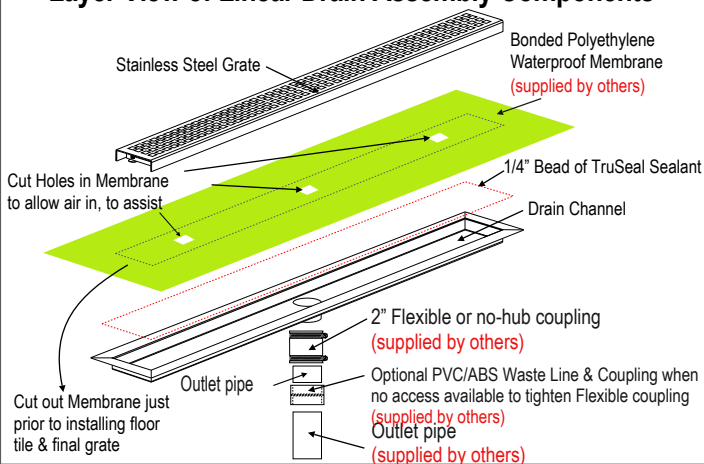

Intermediate Placement

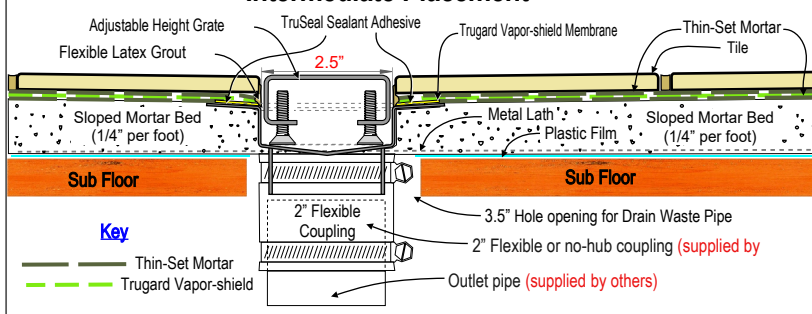

Wall Placement Detail

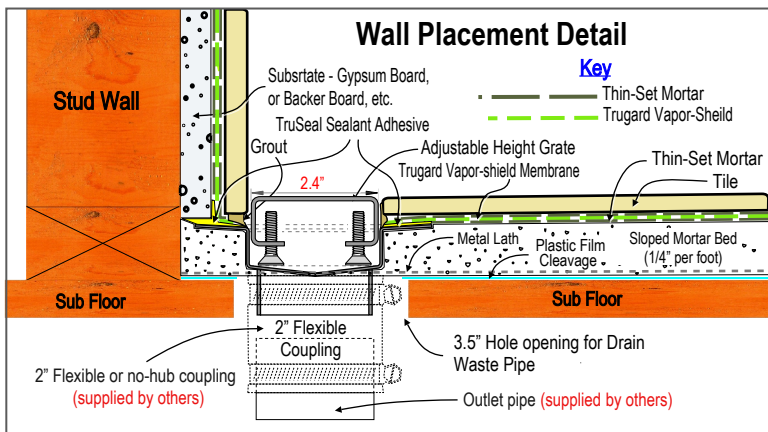

Wall Placement Detail

